

Hopper Loader FG 422./81 (38)

- Modular and compact design
- Material hopper made of aluminium cast alloy
- With separate blower station
- Cleaning of conveying air filter by reversed airflow
- Shuttle valve actuated by lifting magnet or pneumatic cylinder
- Operator-friendly μ P-controller
- Programmable control functions for
 - conveying
 - filter cleaning
 - proportioning/dosing valve
 - purging valve
- Operating status indicated by LEDs
- End of conveying cycle via time or level
- Connection possibilities for external
 - level switch
 - start/stop switch
 - alarm
- Low-noise operation
- Options:
 - level switch
 - separate controller
 - central filter



Hopper Loader FG 422._/81 (38)

Application

The FG 422._/81 (38) Hopper Loader is used in factories of the plastics, rubber, chemical and recycling industries for the automatic feeding of hoppers, scales, mixers, dosing units, drying

plants and processing machines with pellets. The basic version of the unit consists of a feed station and a blower station.

Technical data

Feed station

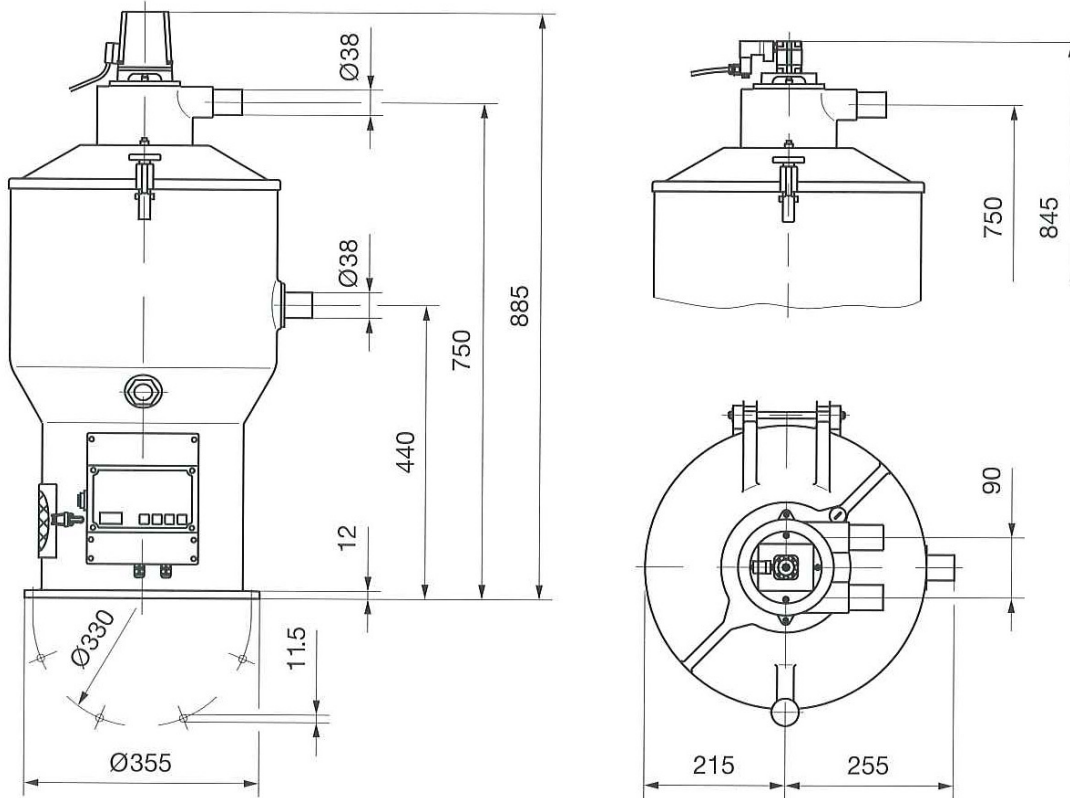

• Conveying line diameter	mm	Ø 38
• Material to be conveyed		Pellets/reclaimed mat.
• Conveying capacity ¹⁾	kg/h	max. 800
• Material hopper		
– Material		Aluminium cast alloy
– Net volume	l	20

• Conveying air filter			
– Version			basket-supported filter
– Material			PET needled felt
– Surface	m ²		0.24
• Paint			RAL 5018
• Noise emissions	dB (A)		< 80
• Weight	kg		27

¹⁾ conveying of PE pellets over a distance of 15 m, of which 4 m are vertical.

For the technical data of the blower station, please refer to leaflet VKD 425.